



# **Balance Edge**

## **Installation Instructions**

NOTES: Please check for any damage caused by the shipping company and take appropriate steps to file a claim, if needed.

\*Please call **Digsafe** and check for any underground utilities before digging anywhere.

### **Materials needed**

Cordless drill/driver, T25 bit, tape measure, post hole digger or auger, hand tamp, and and fourteen (14) 50lb bags of fast-setting premixed concrete (not included). Concrete amount required may very depending on how deep you can get the holes. Concrete amounts can be easily calculated at <http://www.quikrete.com/Calculator/Main.asp>.

### **Instructions**

1. Check with your local playground safety codes for use zone requirements.
2. Remove items from pallet or packaging. You should find one (1) 2x8 balance edge, two (2) 2x4 or 2x6 legs, and one (1) package of hardware.
3. Attach the legs to the balance edge. All pieces are marked/labeled.
4. Move the balance edge to desired location and mark the location of the balance edge legs, referencing the attached drawing.
5. Move the balance edge assembly slightly away from marked locations to give you room to dig post holes, using post hole digger or auger.
6. Set the two post hole diameters to 8", and post hole depths to approximately 3'-6" (depending on region) below final grade/fall zone material. The bottom of hole should "flare" out a little to create a bell shape to prevent frost heaving the post where applicable. Check local codes for the frost line in your area.

\*Note: If you want the balance edge to be raised off the ground, dig your post holes accordingly granted it's not being installed in a location where frost heaving is a concern.

If you encounter immovable objects the legs can be trimmed so the grade marks on the legs end up at finished grade.

7. Using the hand tamp, compact any loose material at the bottom of the hole.
8. Test fit the balance beam assembly in the post holes and make any adjustments to the hole location and the length of the legs so the legs are at the appropriate height and surrounded by equal amounts of concrete when poured.
9. Fill the bottom 6" of hole with drainage stone. Then lift balance edge assembly and set the bottom of the legs into the post holes so grade mark is at grade. Again, trim the bottom of the posts if necessary.
10. Using a bubble level, check the level of the balance edge assembly horizontally by placing the level across the top of the beam. Once level, it is optional to hold this positioning by using strapping and stakes, but it is not required.

# **Balance Edge**

## **Installation Instructions**

11. Fill 1/4 of the hole with fast setting concrete mix and add water per instructions on bag. Recheck to make sure balance edge is level, and make any adjustments.
12. Fill the rest of the hole with concrete per instructions on bag, stopping four inches below subgrade. Recheck to make sure balance edge assembly is level periodically while concrete cures. Let cure for 24 hours.
13. Backfill hole and hand tamp good draining soil firmly to 3" below finished grade, or if installing fall zone on top of grade, then hand tamp soil to subgrade. Install fall zone material to finish grade.
14. All wood is treated with kid-friendly preservative, but as is the case with all wood facing the elements, it needs to be cared for, so check it periodically for rough spots, splinters, etc, and sand them out, and treat it with kid-friendly wood preservative (we have it available if you can't find it) once or twice a year to keep the wood from deteriorating.
15. Enjoy your Balance Edge!



# Balance Edge

## Installation Instructions

**1** BALANCE EDGE  
SCALE 3/4" = 1'-0"

MATERIALS LIST					
PARTS	SIZE: W x H x L	# OF PARTS	FASTENERS	SHOP ORDER	QTY.
WALKING EDGE	2x8 x 8'	1	----	2x8 x 8'	1
STAKES/POSTS	2x4 x 3'	2	3 OF 2.5" SCREWS/PART	2x4 x 8'	1

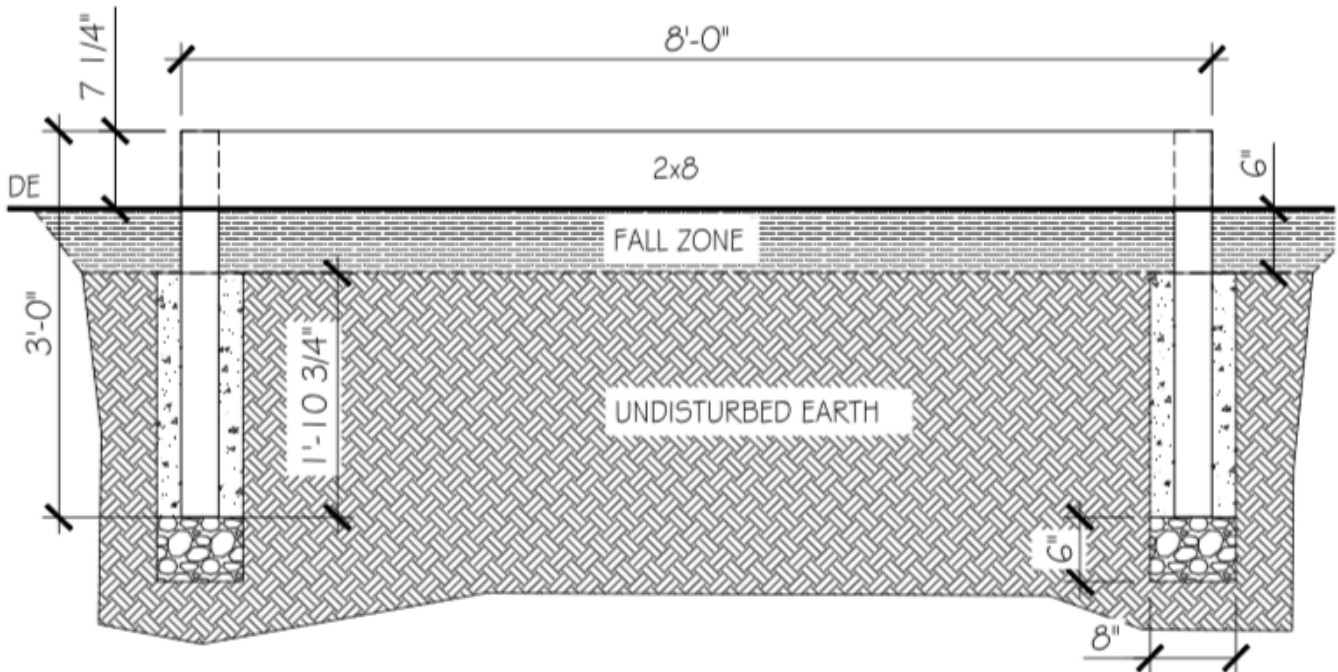
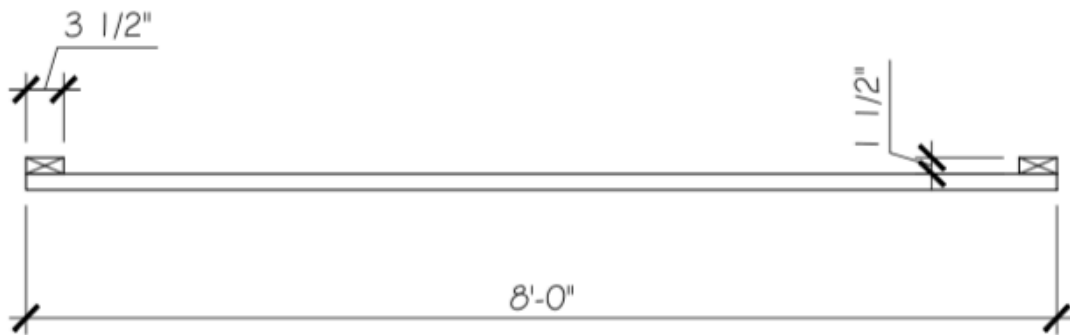

NATURAL PLAYGROUNDS CO.  
85 WARREN ST.  
CONCORD, NH 03301  
(888)-290-8405  
www.naturalplaygrounds.com

PROJECT: BALANCE EDGE (STANDARD SECTION-16')

DRAWN BY: MK      DATE: 03/16/18  
SCALE: AS NOTED      REV: 03/16/18

SHEET TITLE

P-1